

QUANTUM QC3

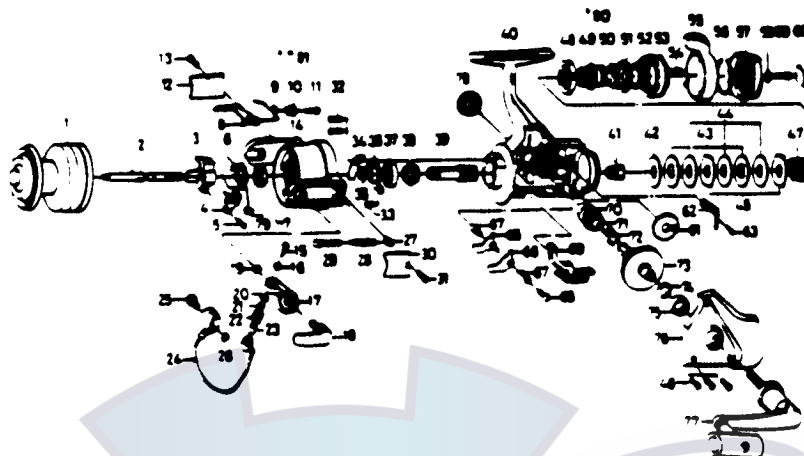

KEY PART NO.	DESCRIPTION	PRICE	KEY PART NO.	DESCRIPTION	PRICE
1 MT321-1	SPOOL ASSY. EXTRA	6.02	42 MTO39	DRAG WASHER B	1.66
2 MT321	SPOOL ASSY. (MAIN)	6.02	43 MTO41	EARED WASHER	1.83
3 MT315	MAIN SHAFT	3.16	44 MTO46	DRAG WASHER C	1.83
4 MTO83	OSCILLATING SLIDER	1.83	45 MTO30	KEY WASHER	1.83
5 MT161	OSC. SLIDER RETAINER	.85	46 MTO57	SIDE COVER SCREW	2.87
6 MTO88	OSC. SLIDER SCREW	.85	47 MTO31	DRAG COIL SPRING	1.27
7 MTO06	ROTOR NUT LOCK WASHER	1.27	48 MT112	DRAG NUT A	3.39
8 MTO19	ROTOR NUT	1.27	49 MT121	DRAG SCREW	1.43
9 MTO49	BAIL TRIP LEVER	1.72	50 MT106	DRAG SCREW WASHER A	.98
10 MT137	BAIL TRIP LEVER SPRING	.85	51 MT110	DRAG HOLDER	1.83
11 MTO37	BAIL TRIP LV. BUSHING	.98	52 MT111	DRAG SCREW WASHER B	.98
12 MTO24	BAIL TRIP LEVER SCREW	.85	53 MT117	DRAG NUT B	4.53
13 MTO85	BAIL TRIP COVER	1.09	54 MT118	DRAG SPRING	1.09
14 MTO09	BAIL SPG COVER SCRW	1.09	55 MTO94	POWER LEVER	4.53
15 MT108	ROTOR	4.87	56 MTO95	POWER LEVER RETAINER	.46
16 MT102	BAIL SCREW	1.27	57 MTO32	DRAG KNOB	3.39
17 MTO07	LOCK WASHER	.46	58 MT119	DRAG KNOB WASHER	.85
18 MT115	BAIL ARM	1.66	59 MTO79	DRAG KNOB SCREW	.85
19 MTO02	CAM CAST LEVER	5.68	60 MT120	DRAG KNOB NAME PLATE	1.27
20 MTO17	CAM CAST LV. RETAINER	.46	61 MTO53	OSCILLATING GEAR	1.43
21 MTO15	LINE ROLLER COLLAR	.46	62 MTO68	CLICK LEAF SPRING	.98
22 MTO04	LINE ROLLER	.46	63 MTO67	CLICK LEAF SPRING SCRW	.85
23 MTO16	LINE ROLLER BUSHING	.46	64 MTO14	ANTI-REV PAWL COLLAR	.98
24 MT347	LINE ROLLER	1.72	65 MTO63	ANTI-REV. PAWL A	1.09
25 MTO44	BAIL	3.73	66 MTO64	ANTI-REV. PAWL B	1.27
26 MTO03	BAIL HOLDER PIN	1.83	67 MTO61	ANTI-REV PAWL SPG A	.85
27 MTO20	BAIL TRIP CAN RET.	.85	68 MTO89	ANTI-REV PAWL SCREW	.85
28 MTO22	BAIL SPG SHAFT HLDR	.98	69 MTO59	ANTI-REV. LEVER	1.27
29 MTO29	BAIL SPRING	.46	70 MTO52	BUSHING	2.24
30 MTO87	BAIL SPRING SHAFT	1.09	71 MT253	OSCILLATING PN GEAR	1.66
31 MTO85	BAIL SPRING COVER	.98	72 MTO86	ANTI-REV PAWL SPG B	.98
32 MTO80	BAIL SPG COVER SCRW	1.09	73 MTO12	DRIVE GEAR	10.26
33 MTO93	BEARING RET. SCREW A	.98	74 MTO26	DRIVE GEAR WASHER	.46
34 MTO82	BEARING RET. SCREW B	.98	75 MT157	BALL BEARING	9.12
35 MTO27	BAIL TRIP PLATE	1.43	76 MT323	SIDE COVER	5.68
36 MTO40	PINION WASHER	.85	77 MT318	HANDLE ASSY.	10.26
37 MTO28	BEARING RETAINER	1.72	78 MTO73	HANDLE SCREW CAP	2.30
38 MTO60	BALL BEARING	9.12	79 MTO58	RTR NUT LOCK SCREW	.85
39 MTO11	ANTI-REV. RATCHET	3.55	*80 MT121	DRAG SCREW	1.43
40 MT301	PINION GEAR	6.59	**81 MT122	BAIL TRIP LEVER WSHR	.46
41 MTO66	BODY	9.12			
	CLICK GEAR	1.83			

*Not pictured
Located between Keys 48 & 50

**Not pictured
Located between Keys 10 & 11

Prices subject to change without notice. Prices do not include postage and handling.

PLEASE ORDER BY PART NUMBER

Rev. 11/90

Zabes Division Brunswick Corporation, Box 270, Tulsa, OK 74101 USA 918-639-6681

